

UNIT, DIRECT SUPPORT, AND GENERAL SUPPORT MAINTENANCE
REPAIR PARTS AND SPECIAL TOOLS LIST
TRUCK, 5-TON, 6X6, M809 SERIES TRUCKS (DIESEL)

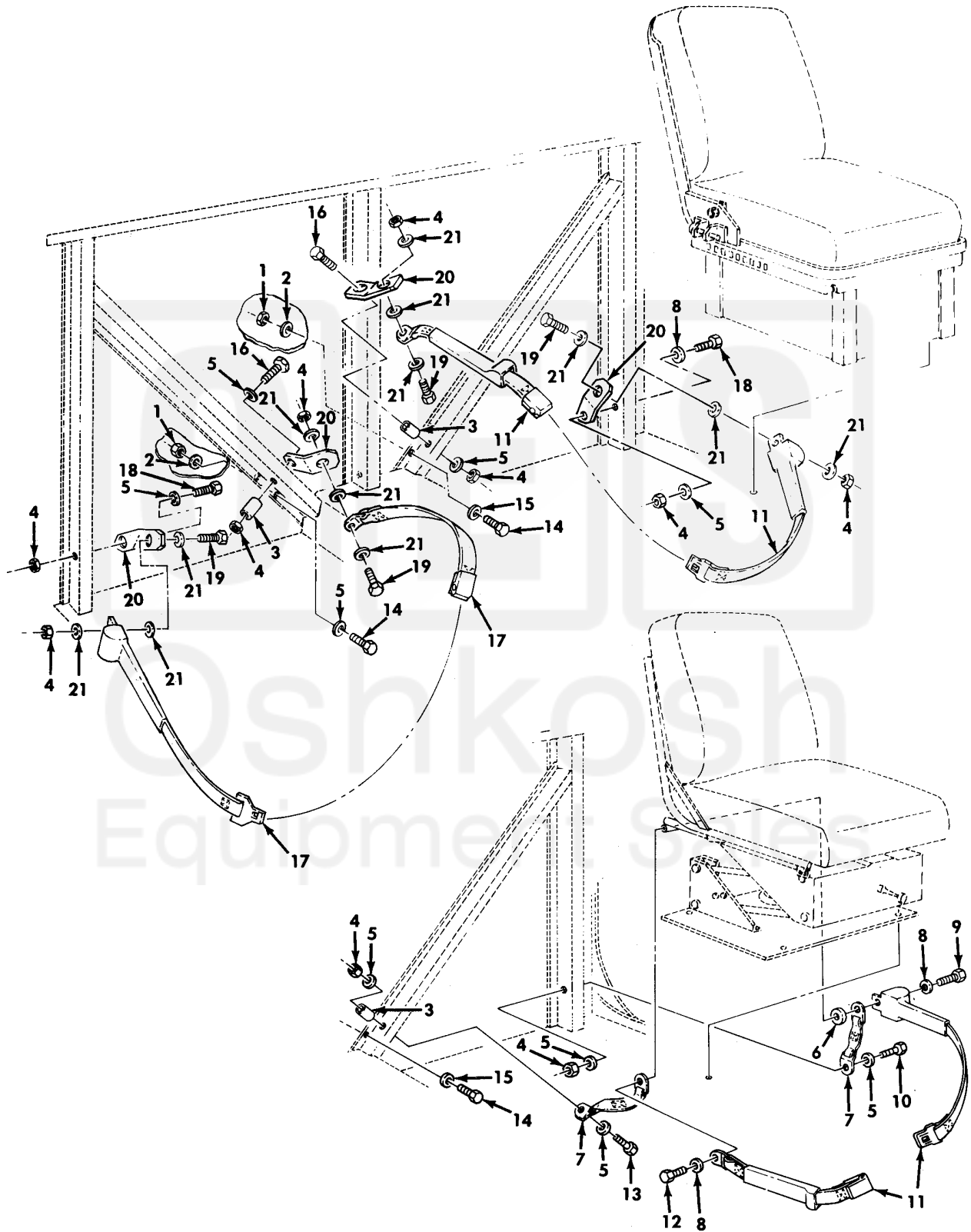

Figure 478. Seat Belt Kit, Fixed and Floating Driver's Seat.

(1) ITEM NO	(2) SMR CODE	(3) NSN	(4) CAGEC	(5) PART NUMBER	(6) DESCRIPTION AND USABLE ON CODE (UOC)	(7) QTY
GROUP 3307 SPECIAL PURPOSE KITS						
FIG. 478 SEAT BELT KIT, FIXED AND FLOATING DIRVER'S SEAT						
1	PAOZZ	5310-00-982-4912	96906	MS21045-5	NUT, SELF-LOCKING, HE 12301438.....	4
2	PAOZZ	5310-01-132-8275	24617	9418924	WASHER, FLAT 12301438.....	4
3	KFOZZ		19207	12301343	SLEEVE 12301438.....	4
4	PAOZZ	5310-00-488-3888	96906	MS51943-40	NUT, SELF-LOCKING, HE 12301438.....	14
5	PAOZZ	5310-00-809-5998	96906	MS27183-18	WASHER, FLAT 12301438.....	11
6	KFOZZ		19207	12301487	SPACER 12301438.....	1
7	PAOZZ	2540-01-245-2445	19207	12301489	BELT, VEHICULAR SAFE 12301438.....	2
8	PAOZZ	5310-00-003-4094	01276	210104-8S	WASHER, LOCK 12301438.....	3
9	PAOZZ	5305-00-709-8537	96906	MS90727-94	SCREW, CAP, HEXAGON H 12301438.....	1
10	PAOZA	5305-00-719-5243	96906	MS90727-119	SCREW, CAP, HEXAGON H 12301438.....	1
11	PAOZZ	2540-01-460-8881	19207	12301442-3	BELT, VEHICULAR SAFE 12301438.....	3
12	PAOZZ	5305-00-914-6133	96906	MS18153-88	SCREW, CAP, HEXAGON H 12301438.....	1
13	PAOZZ	5305-00-719-5262	96906	MS90727-121	SCREW, CAP, HEXAGON H 12301438.....	1
14	PAOZZ	5305-00-051-4075	96906	MS90727-33	SCREW, CAP, HEXAGON H 12301438.....	4
15	PAOZZ	5310-00-081-4219	96906	MS27183-12	WASHER, FLAT 12301438.....	3
16	PAOZZ	5305-00-719-5244	80204	B1821BH050F325N	SCREW, CAP, HEXAGON H 12301438.....	2
17	PAOZZ	2540-01-286-7674	19207	12301346	BELT, VEHICULAR SAFE 12301438.....	4
18	PAOZZ	5305-00-719-5241	96906	MS90727-118	SCREW, CAP, HEXAGON H 12301438.....	3
19	PAOZZ	5305-00-719-5219	96906	MS90727-111	SCREW, CAP, HEXAGON H 12301438.....	4
20	PAOZZ	5340-01-290-6370	19207	12301344	BRACKET, ANGLE 12301438.....	6
21	PAOZZ	5310-00-656-0114	96906	MS15795-819	WASHER, FLAT 12301438.....	18
KIT	PAOZZ	2540-01-245-2444	19207	12301438	BELT, VEHICULAR SAFE (3) 478-11 BELT, VEHICULAR SAFE (4) 478-17 BELT, VEHICULAR SAFE (2) 478-7 BRACKET, ANGLE (6) 478-20 NUT, SELF-LOCKING, HE (4) 478-1 NUT, SELF-LOCKING, HE (14) 478-4 SCREW, CAP, HEXAGON H (4) 478-14 SCREW, CAP, HEXAGON H (1) 478-12 SCREW, CAP, HEXAGON H (1) 478-9 SCREW, CAP, HEXAGON H (3) 478-18 SCREW, CAP, HEXAGON H (1) 478-10 SCREW, CAP, HEXAGON H (2) 478-16 SCREW, CAP, HEXAGON H (1) 478-13 SCREW, CAP, HEXAGON H (4) 478-19 SLEEVE (4) 478-3 SPACER (1) 478-6	1

(1) ITEM NO	(2) SMR CODE	(3) NSN	(4) CAGEC	(5) PART NUMBER	(6) DESCRIPTION AND USABLE ON	(7) CODE (UOC) QTY
					WASHER, FLAT	(3) 478-15
					WASHER, FLAT	(11) 478-5
					WASHER, FLAT	(4) 478-2
					WASHER, FLAT	(18) 478-21
					WASHER, LOCK	(3) 478-8

END OF FIGURE

